

Technical Specifications

<p>PA-SYSTEM</p> <ul style="list-style-type: none"> • 4x Alcons LR7 / Side (Main) • 3x Alcons BF121B (Subs) • 2x Alcons VR5 (Delayline) 	<p>MONITORING</p> <ul style="list-style-type: none"> • 4x Alcons VR5 (8" passive Speaker) • 2x l'Acoustics 112p (12" active) • Monitoring from FoH-Desk 	<p>DESK</p> <ul style="list-style-type: none"> • Yamaha QL-5 • 2x Yamaha RIO1608-D2
<p>MICROPHONES</p> <ul style="list-style-type: none"> • 1x Shure beta91 • 1x Shure beta52 • 1x Audix D6 • 2x Audix SCX25A • 4x AKG C414 XLS • 2x Neumann U87 • 1x Earthworx PM40- System • 4x Sennheiser e904 • 4x Shure sm57 • 1x Shure sm58 S • 2x Sennheiser md421 • 2x Sennheiser md441 • 2x Electrovoice RE20 • 1x Sennheiser e906 • 6x Neumann KM184 • 4x dpa 4011 • 2x dpa 4060 • 20x dpa 4099 (div. Adapters for Brass, Strings, Drums...) • 4x Sennheiser e935 • 1x Neumann KMS105 • 2x Sennheiser EW500 / KMS105 • 6x active DI's / 2x Stereo passive DI's 	<p>BACKLINE</p> <ul style="list-style-type: none"> • Drums: Sonor SQ2 Maple Shells • 2 x Bassdrum: 20" x 15" (front head with hole for mic; with pedal) 18" x 14" (closed front head, with pedal) • 1x Tom 10" x 7" + 1x Tom 12" x 8" • 1x Floortom 14" x 14" • 2x Snare 14" x 6,5" + 14" x 4,25" • 2x cymbalstands with boom arm • 2x cymbalstands (normal) • 1x Hihat Machine • Please note: no cymbals and no hihat clutch on side. Bring your own cymbals and clutch please! • Steinway D-274 Grand Piano (443Hz Tuning) • Steingraeber A-170 (+ MIDI-Function) • Mark Bass Mini CMD 121P • Fender Hot Rod Deluxe 	<p>LIGHT</p> <ul style="list-style-type: none"> • Grand MA on PC + PC-Wing • NO HAZE / FOG-Machine! <p>Permanent, nonflexible Light Setup:</p> <p>Front Truss: 2x Robe T1 Profile, 4x LED-Fresnel (RGB), 1x LED-Profile (RGB)</p> <p>Mid Truss: 4x LED-Fresnel (RGB), 6x Mini-LED-Fresnel (only white)</p> <p>Back Truss: 2x Robe T1 Profile, 2x LED-Fresnel (RGB), 6x Mini-LED-Fresnel (only white)</p> <p>BEAMER</p> <ul style="list-style-type: none"> • Optoma ZU860 / 8.500 Lumen Laser WUXGA DLP Projektor (1920x1200) • Movable Screen behind Back-Truss

Saalplan

max. 199 PAX BESTUHLT

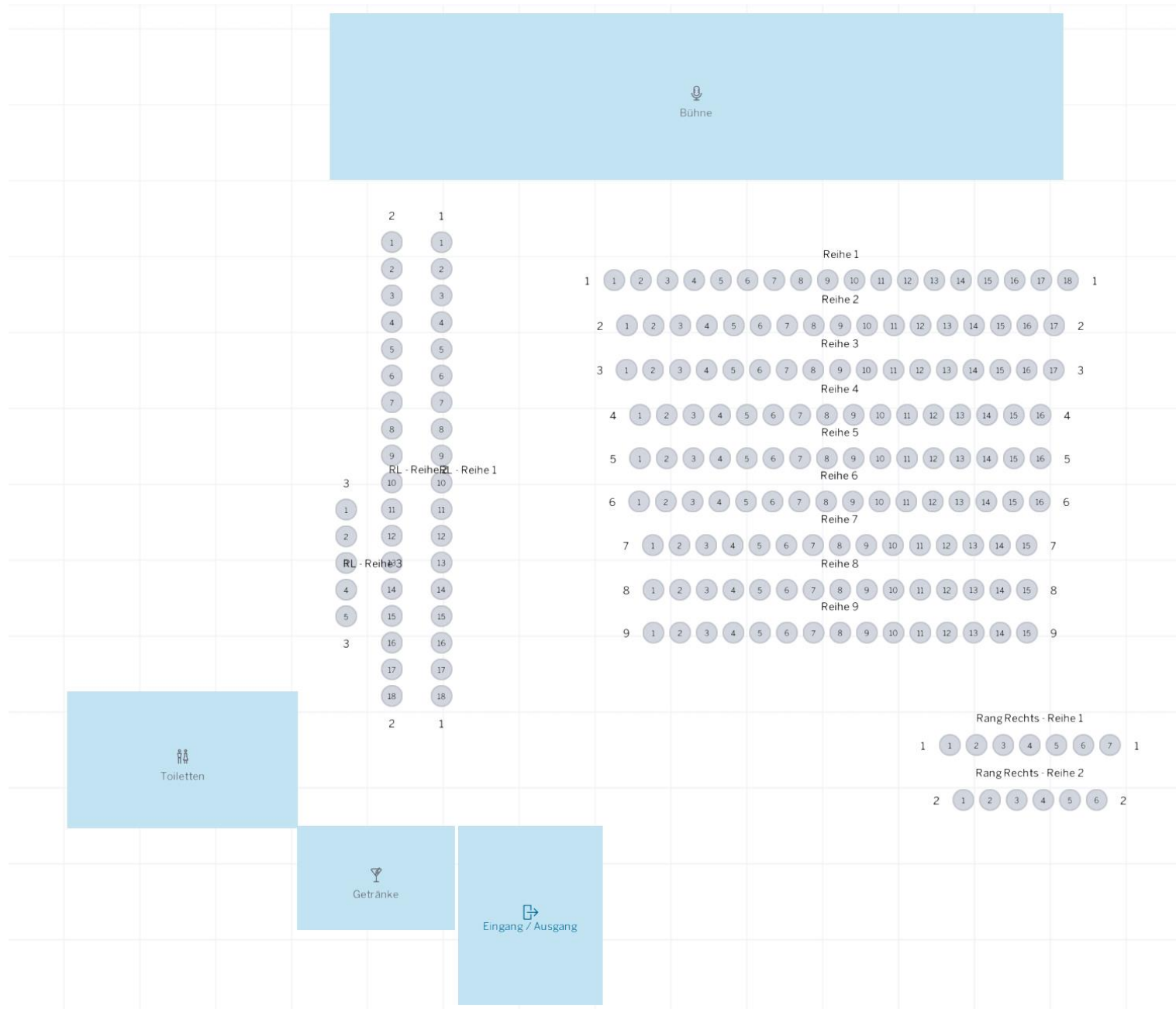

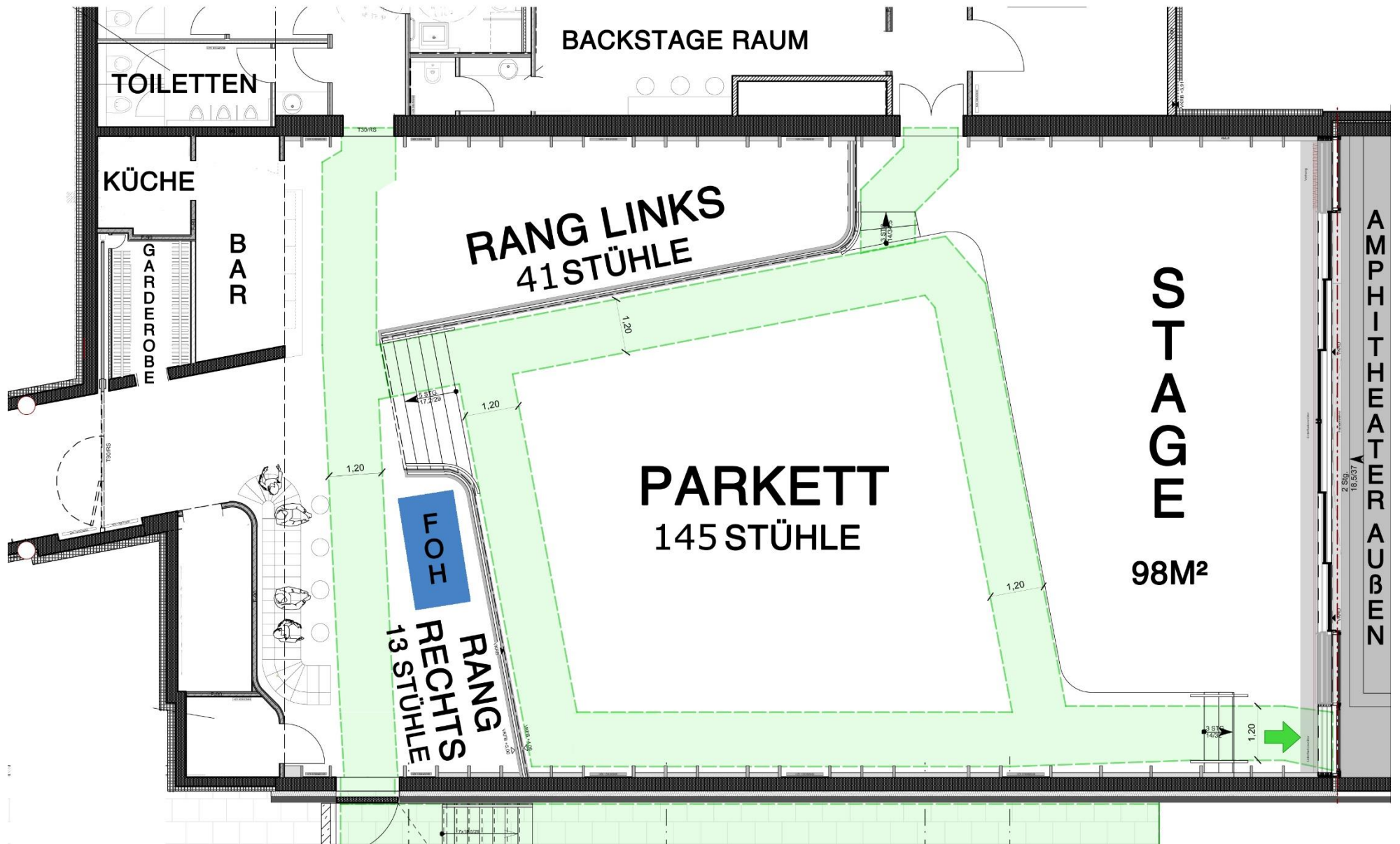



1 - Blick von der Bühne (mit Steinway D) in den Saal



2 - Blick vom Parkett auf die Bühne – mit regulärer Konzertbestuhlung



3 - Bar by Cornelia Poletto



4 - Blick vom Rang Links in den Saal - mit alternativer Bestuhlung



5 - Backstage Raum mit Schließfächern und eigener Toilette – keine Dusche – im vorderen Bereich zusätzlich ein großer Tisch + Stühle